

Camp Icimani

CAMP MAP

LEGEND

-  Flag poles
-  Tent Campsite
-  Fire Circle
-  Creek Access
-  Girls/Women Locker Room
-  Boys/Men Locker Room
-  Water Spigot
- K** Kitchen
- P** Parking Lot
- Hiking Trail
- Road
- Property Line

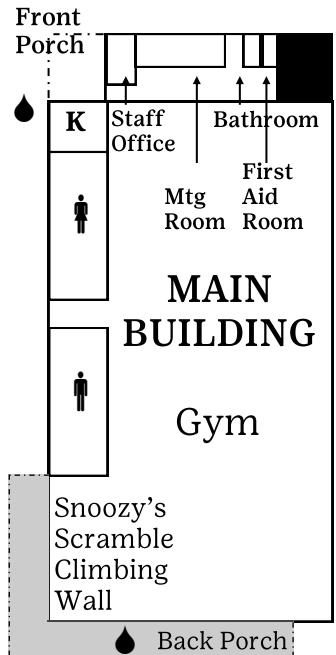
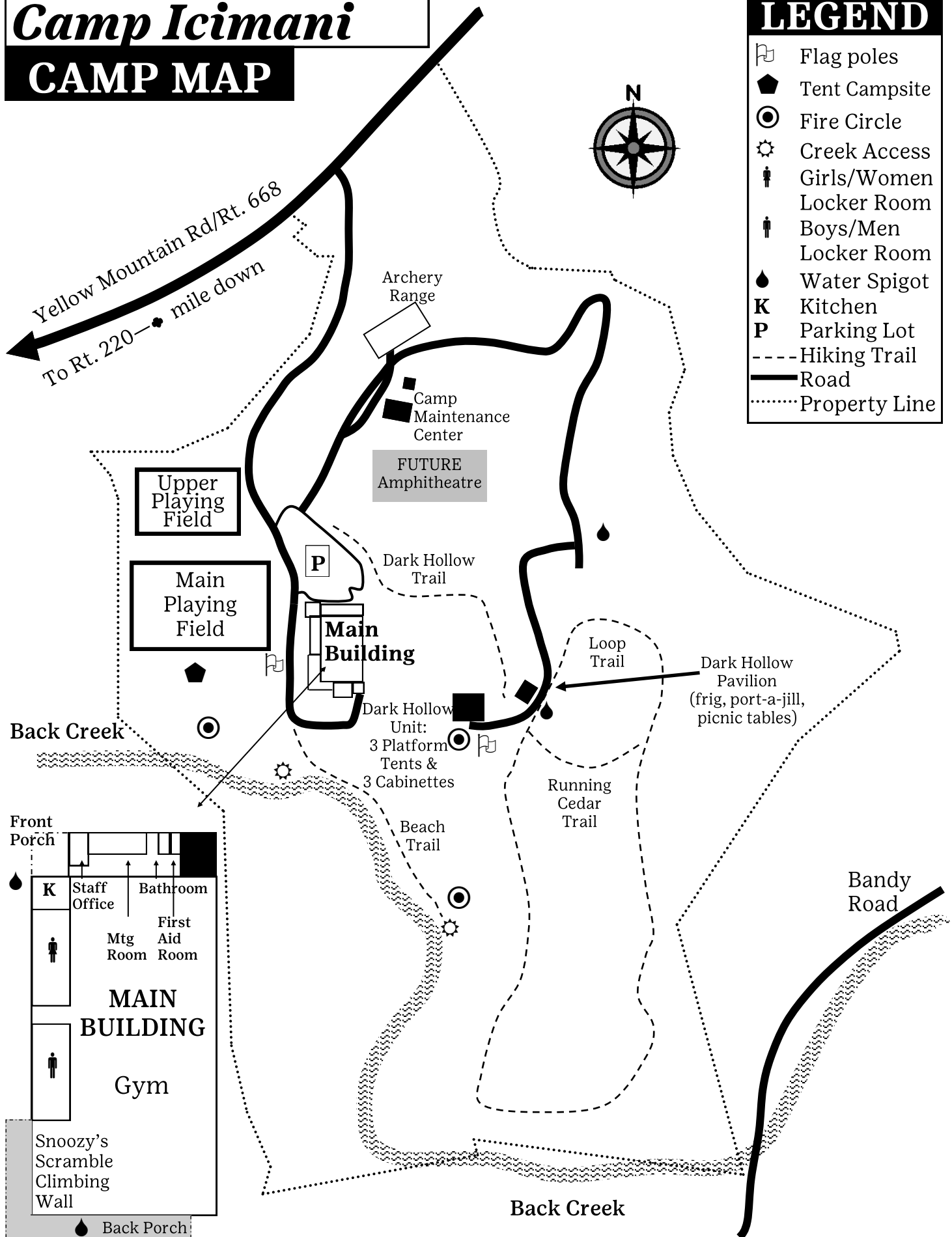

Camp Icimani boasts many hiking trails tracing around camp in the beautiful Blue Ridge Mountains. These trails were adeptly named “Friendship Trails” by Morgan Donelson, of Junior Troop 86, who wrote, “Friendship lasts forever, and trails can be long. A trail is set before you to travel on, so I consider it a trail of friendship. Isn’t that what Girl Scouts are all about? Think of all the friends everyone will make.”

Beach Trail

Trail rating scale: easy **Length (one-way):** 0.11 miles **Trail blaze color:** turquoise
Description: a short friendship trail where you can hike side-by-side next to gorgeous Back Creek. Along the way look out for our resident busy beaver and graceful great white heron. The trail ends at a creek-beach area that banks the waters of Back Creek. A fabulous place to go for a wade in the water or explore the abundant wildlife in and around the creek. The trail can be found near the backside of the main building, right off the deck of the Snoozy’s Scramble Climbing Wall.

Dark Hollow Trail

Trail rating scale: moderate **Length (one-way):** 0.12 miles **Trail blaze color:** lime-green
Description: a trail that gently climbs up the side of the mountain to the ridgeline where the Dark Hollow Unit resides (pavilion, picnic table, platform tents, cabinettes and fire circle). Once at the top, you can explore the nearby Loop Trail or Running Cedar Trail. The trail head can be found in the small field above the parking lot. Named in honor of our former Girl Scout Dark Hollow Camp.

Loop Trail

Trail rating scale: moderate **Length (roundtrip):** 0.57 miles **Trail blaze color:** red
Description: a loop trail that starts and ends in the very same place. The trail head is located in the open field on the top of the mountain. Start to the left or right of the field and then easily descend down the mountainside to Back Creek. This trail shares a small portion of the Dark Hollow Unit’s access road; please be careful to look for cars. The trail loops back up the mountain making the ascent trip a strenuous return.

Running Cedar Trail

Trail rating scale: easy **Length (one-way):** 0.05 miles **Trail blaze color:** orange
Description: a down-up trail that takes you into the “bowl” region of the mountaintop. The trail makes the shape of a “V” connecting two sides of the Loop Trail. The trail can be found right across from the Dark Hollow Trail and off the beginning of either side of the Loop Trail. Its name comes from the running cedar ground cover that blankets the beginning of the trail.